



**FITTING INSTRUCTIONS FOR TH0016**  
**TRANSPORT HOOKS FOR YAMAHA YZF-R6 '17-**



**THIS KIT CONTAINS THE ITEMS PICTURED AND LABELLED BELOW.**  
**DO NOT PROCEED UNTIL YOU ARE SURE ALL PARTS ARE PRESENT.**

Please note that the way the kit is packed does not necessarily represent the way of mounting to the bike.

THE PARTS SHOWN MAY BE REPRESENTATIVE ONLY (FOR CLARITY OF INSTRUCTIONS ONLY).

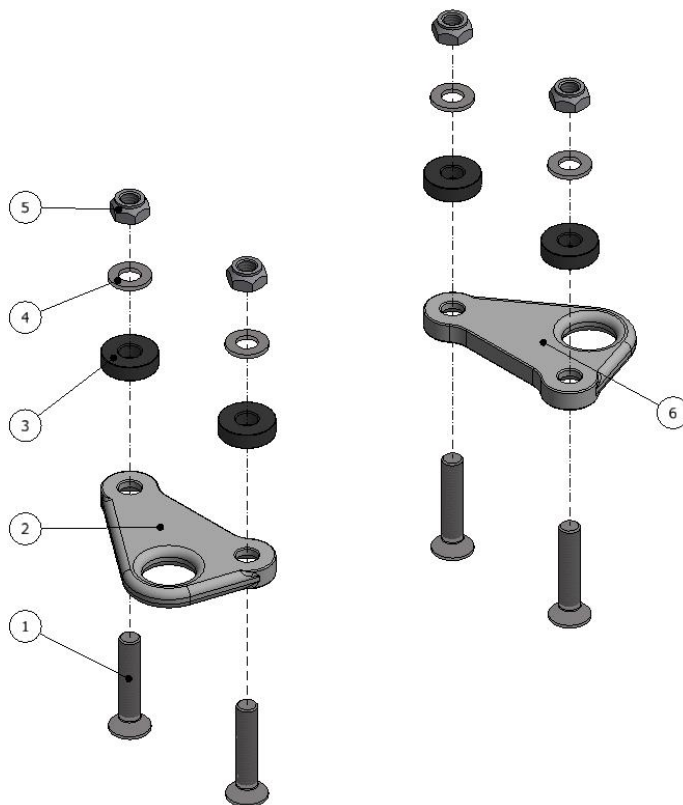



### **LEGEND**

ITEM 1 = M8 x 40mm LONG COUNTERSUNK BOLTS (x4).

ITEM 2 = TRANSPORT HOOK RIGHT (SMW0095) (x1).

ITEM 3 = SPACER (S0623 – 6mm LONG) (x4).

ITEM 4 = M8 WASHER (x4).

ITEM 5 = M8 NYLOC NUT (x4).

ITEM 6 = TRANSPORT HOOK LEFT (SMW0094) (x1).

Please note that in cases where kits are packed with rubber washers holding the components onto the bolt – *the rubber washers should be thrown away!*

### **TOOLS REQUIRED**

- Socket set to include 5 & 6mm socket and wrench.
  - 13mm spanner.

### **GENERAL TORQUE SETTINGS**

M4 BOLT = 8Nm

M5 BOLT = 12Nm

M6 BOLT = 15Nm

M8 BOLT = 20Nm

M10 BOLT = 40Nm

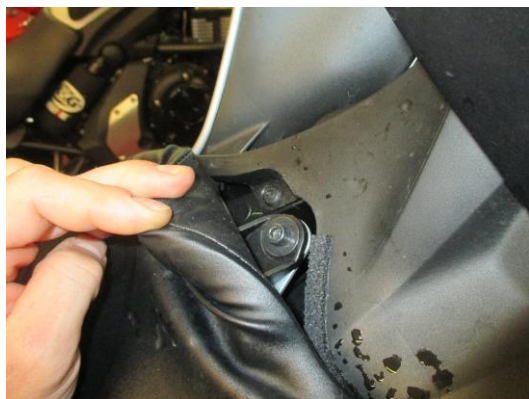

Picture 1

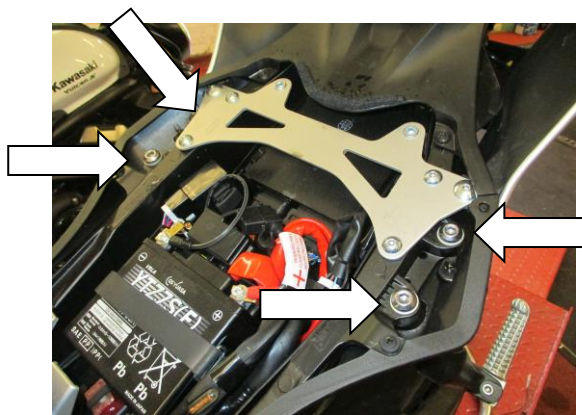

Picture 2

### **FITTING INSTRUCTIONS**

- Remove the riders seat from the bike by lifting the back corner of the seat to access the two mounting bolts, as shown in picture 1.
- Remove the OEM pillion footrests on both sides of the bike by removing the bolts that are arrowed in picture 2.
- Take the left side R&G transport hook (item 2) and position two M8 x 40mm long countersunk bolts (item 1) through the two mounting holes, ensuring the bolts sit in the countersinks, before locating two spacers (item 3) over the exposed threads of the bolts and offer up to the underside of the subframe mounts, before locating two washers and nyloc nuts to the exposed thread on top of the subframe and tighten.
- Fit the right side transport hook (item 6) in the same way as above.
- Ensure the part is correctly fitted before tightening all bolts to the recommended torque values.

R&G Racing

Unit 1, Shelley's Lane, East Worldham, Alton, Hampshire, GU34 3AQ

Tel: +44 (0)1420 89007 Fax: +44 (0)1420 87301 [www.rg-racing.com](http://www.rg-racing.com) Email: [info@rg-racing.com](mailto:info@rg-racing.com)



- Re-fit the seat and tighten the two mounting bolts.
- *Please ensure that when strapping the motorcycle down the ratchet straps do not come into contact with any part of the motorcycle, as the strap is likely to rub during transit and may cause damage.*
- We recommend that fabric from the straps be in contact with the product, as opposed to the hook on the end of the strap. This will increase the lifespan of the protective coating on the product.
- Do not overtighten straps attached to the product, as it would be possible to bend or break the product with excessive force. If in any doubt please consult a professional.
- R&G cannot be held liable for any breakages to straps, or consequential damage from this, as a result of fraying/breaking of the straps, or incorrect use. Please ensure that all bodywork of the motorcycle which may come in contact with the straps (e.g. plastic panels, exhausts, swingarms) are protected or left completely clear of the straps.
- While we may show certain applications where the product is being used for attaching luggage to a motorcycle, this is not a general recommendation and cannot be achieved on all motorcycles.
- Care and attention needs to be taken whenever the product is in use for securing luggage or for tying the motorcycle down. R&G cannot accept any responsibility for inappropriate use or decisions on the part of the user. If in doubt, always consult a professional.

ISSUE 1 11/07/2017 (AR)

**Digital copies of these instructions are available to download from [www.rg-racing.com](http://www.rg-racing.com)**

#### CONSUMER NOTICE

The catalogue description and any exhibition of samples are only broad indications of the Products and R&G may make design changes which do not diminish their performance or visual appeal and supplying them in such state shall conform to the order. The Buyer acknowledges no representation or warranty (other than as to title) has been given or will apply to the Products other than those in R&G's order or confirmation and the Buyer confirms it has chosen the Products as being of merchantable quality and suitable for its particular purposes. Where R&G fits the Products or undertakes other services it shall exercise reasonable skill and care and rectify any fault free of charge unless the workmanship has been disturbed. The Buyer is responsible for ensuring that the warranty on the motorcycle is not affected by the fitting of the Products. On return of any defective Products R&G shall at its option either supply a replacement or refund the purchase money but shall not be liable if the Products have been modified or used or maintained otherwise than in accordance with R&G's or manufacturer's instructions and good engineering practice or if the defect arises from accident or neglect. Other than identified above and subject to R&G not limiting its liability for causing death and personal injury, it shall not be liable for indirect or consequential loss and otherwise its liability shall be limited to the amounts paid by the Buyer for the Products or the fitting or service concerned. These terms do not affect the Buyer's statutory rights.

#### R&G RACING RETURNS POLICY (NON-FAULTY GOODS)

Returns must be pre-authorized (if not pre-authorized the return will be rejected). Goods may only be returned direct to us if they were purchased direct from us (customer must prove if necessary). Otherwise to be returned to original vendor. Goods must be in re-sellable condition, in the opinion of R&G Racing. All returns are subject to a 25% restocking and handling fee (25% of the gross value exc. P&P – at the prevailing price at time of purchase). The customer must pay any and all carriage charges. No returns of discontinued products, unless within 14 days of purchase. This policy does not affect your statutory rights and does not refer to faulty goods.



**NOTICE DE MONTAGE POUR TH0016**  
**ACCROCHES DE TRANSPORT YAMAHA YZF-R6 '17-**



**Le kit contient les articles exposés ci-dessous, vérifier que toutes les pièces soient présentes avant de procéder au montage.**

**La façon dont le kit est emballé ne correspond pas forcément à la façon de monter les pièces sur la moto.**

**LES PARTIES PRESENTEES PEUVENT ETRE UNIQUEMENT REPRESENTATIVES (POUR LA CLARTE DES INSTRUCTIONS UNIQUEMENT).**

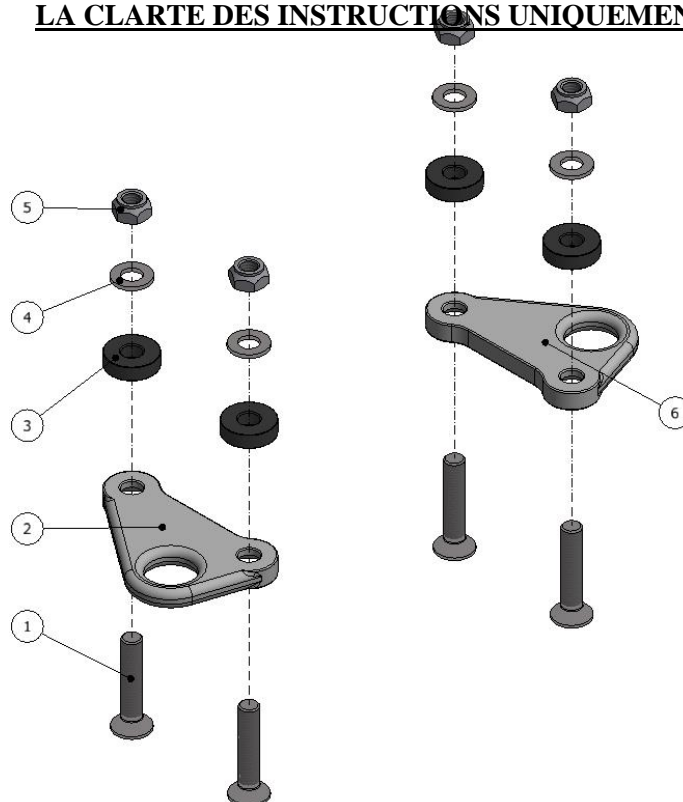



### LÉGENDE

- ARTICLE 1 = M8 x 40mm BOULONS (x4).  
 ARTICLE 2 = ACCROCHE DE TRANSPORT DROITE (SMW0095) (x1).  
 ARTICLE 3 = SPACER (S0623 – 6mm DE LONG) (x4).  
 ARTICLE 4 = M8 RONDELLE (x4).  
 ARTICLE 5 = M8 ÉCROU (x4).  
 ARTICLE 6 = ACCROCHE DE TRANSPORT GAUCHE (SMW0094) (x1).

Notez que si les kits sont emballés avec des rondelles en caoutchouc servant à tenir les composants, *ces rondelles doivent être jetées !*

### OUTILS REQUIS

- Clés à molette 5 & 6mm.
- Clé à molette 13mm.

### VALEURS DE SERRAGE RECOMMANDEES

- M4 BOULON = 8Nm  
 M5 BOULON = 12Nm  
 M6 BOULON = 15Nm  
 M8 BOULON = 20Nm  
 M10 BOULON = 40Nm

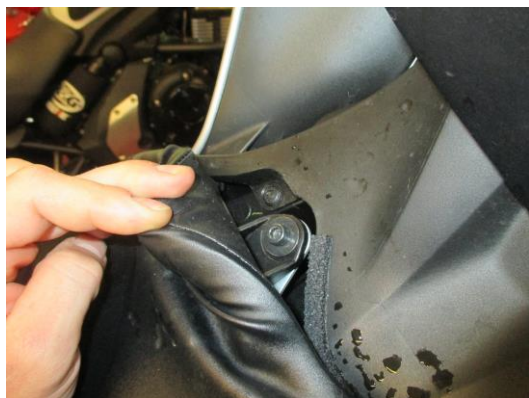

Photo 1

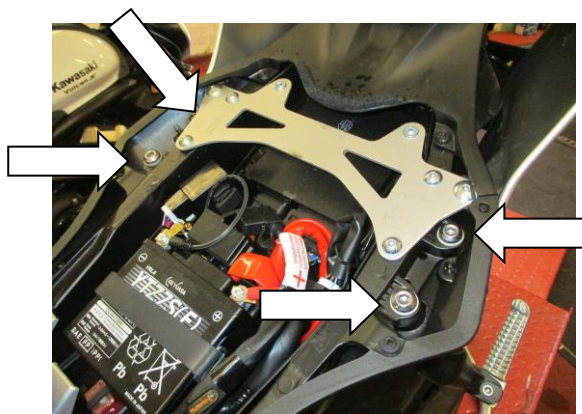

Photo 2

### NOTICE DE MONTAGE

- Enlever les sièges en soulevant le coin arrière du siège pour accéder aux 2 boulons de fixation, voir photo 1.
- Enlever les repose pieds passage d'origine des 2 côtés de la moto en enlevant les boulons indiqués sur la photo 2.
- Prendre l'accroche de transport R&G du côté gauche (article 2) et positionner 2 boulons M8 x 40mm (article 1) dans les 2 trous de fixation, en vous assurant que les boulons se placent dans les contre alésages, avant de placer 2 entretoises (article 3) sur les extrémités de filetage des boulons puis montez le au-dessous



des supports de sous-cadre, puis placez 2 rondelles et écrous sur le filetage sur le haut du sous cadre puis serrer.

- Monter l'accroche de transport du côté droit (article 6) de la même façon que ci-dessus.
  - Veiller à ce que le montage soit correct avant de serrer tous les boulons selon les Valeurs de serrage recommandées.
  - Remonter le siège et serrer les 2 boulons de fixation.
- 
- Veiller à ce que lorsque la moto est sanglée, les sangles ne touchent pas la moto, car cela pourrait abimer la moto lors du transport.
  - Nous recommandons que le tissu des sangles soit en contact avec le produit, par opposition à l'accroche sur l'extrémité de la sangle. Cela améliorera la durée de vie du revêtement de protection du produit.
  - Ne pas trop serrer les sangles attachées au produit, car cela pourrait endommager le produit si une force excessive est émise dessus. En cas de doute, consulter un professionnel.
  - R&G ne pourra être tenue responsable en cas de rupture des sangles, ou dommages consécutifs à cette rupture et à une mauvaise utilisation. Veiller à ce que tous les carénages de la moto qui pourraient être en contact avec les sangles, soit protégés (e.g. panneau plastique, échappement, bras oscillant) ou suffisamment éloignés des sangles.
  - Même si nous présentons quelques applications du produit, tel que l'attache de bagage, il ne s'agit par d'une recommandation générale et cela peut ne pas être possible selon le modèle de moto.
  - Lorsque le produit est utilisé, vous devez faire preuve d'une attention particulière dans la fixation du bagage ou atteler la moto. R&G n'acceptera aucune responsabilité en cas d'utilisation inappropriée et décision propre à l'utilisateur. En cas de doute, consultez un professionnel.

ISSUE 1 11/07/2017 (AR)

**Notice disponible au téléchargement sur [www.rg-racing.com](http://www.rg-racing.com)**

#### CONSUMER NOTICE

The catalogue description and any exhibition of samples are only broad indications of the Products and R&G may make design changes which do not diminish their performance or visual appeal and supplying them in such state shall conform to the order. The Buyer acknowledges no representation or warranty (other than as to title) has been given or will apply to the Products other than those in R&G's order or confirmation and the Buyer confirms it has chosen the Products as being of merchantable quality and suitable for its particular purposes. Where R&G fits the Products or undertakes other services it shall exercise reasonable skill and care and rectify any fault free of charge unless the workmanship has been disturbed. The Buyer is responsible for ensuring that the warranty on the motorcycle is not affected by the fitting of the Products. On return of any defective Products R&G shall at its option either supply a replacement or refund the purchase money but shall not be liable if the Products have been modified or used or maintained otherwise than in accordance with R&G's or manufacturer's instructions and good engineering practice or if the defect arises from accident or neglect. Other than identified above and subject to R&G not limiting its liability for causing death and personal injury, it shall not be liable for indirect or consequential loss and otherwise its liability shall be limited to the amounts paid by the Buyer for the Products or the fitting or service concerned. These terms do not affect the Buyer's statutory rights.

#### R&G RACING RETURNS POLICY (NON-FAULTY GOODS)

Returns must be pre-authorized (if not pre-authorized the return will be rejected). Goods may only be returned direct to us if they were purchased direct from us (customer must prove if necessary). Otherwise to be returned to original vendor. Goods must be in re-sellable condition, in the opinion of R&G Racing. All returns are subject to a 25% restocking and handling fee (25% of the gross value exc. P&P – at the prevailing price at time of purchase). The customer must pay any and all carriage charges. No returns of discontinued products, unless within 14 days of purchase. This policy does not affect your statutory rights and does not refer to faulty goods.

R&G Racing

Unit 1, Shelley's Lane, East Worldham, Alton, Hampshire, GU34 3AQ

Tel: +44 (0)1420 89007 Fax: +44 (0)1420 87301 [www.rg-racing.com](http://www.rg-racing.com) Email: [info@rg-racing.com](mailto:info@rg-racing.com)